

specification for GBH glass landing door **RSZ-S1**, door drive underneath

Company		Door width (mm)		General remarks
Name		Door height (mm)		
Phone		Car door (Qty)		
Fax				
e-Mail		landing door (Qty)		
Key word				

GBH Design GmbH	
Aufzugskomponenten	
Am Branden 2	
D-85256 Vierkirchen	
Technik Christian Gratzl	
Telefon: +49 8139 9321-316	
Telefax: +49 8139 9321-301	www.gbh-design.de
senden an: christian.gratzl@gbh-design.de	

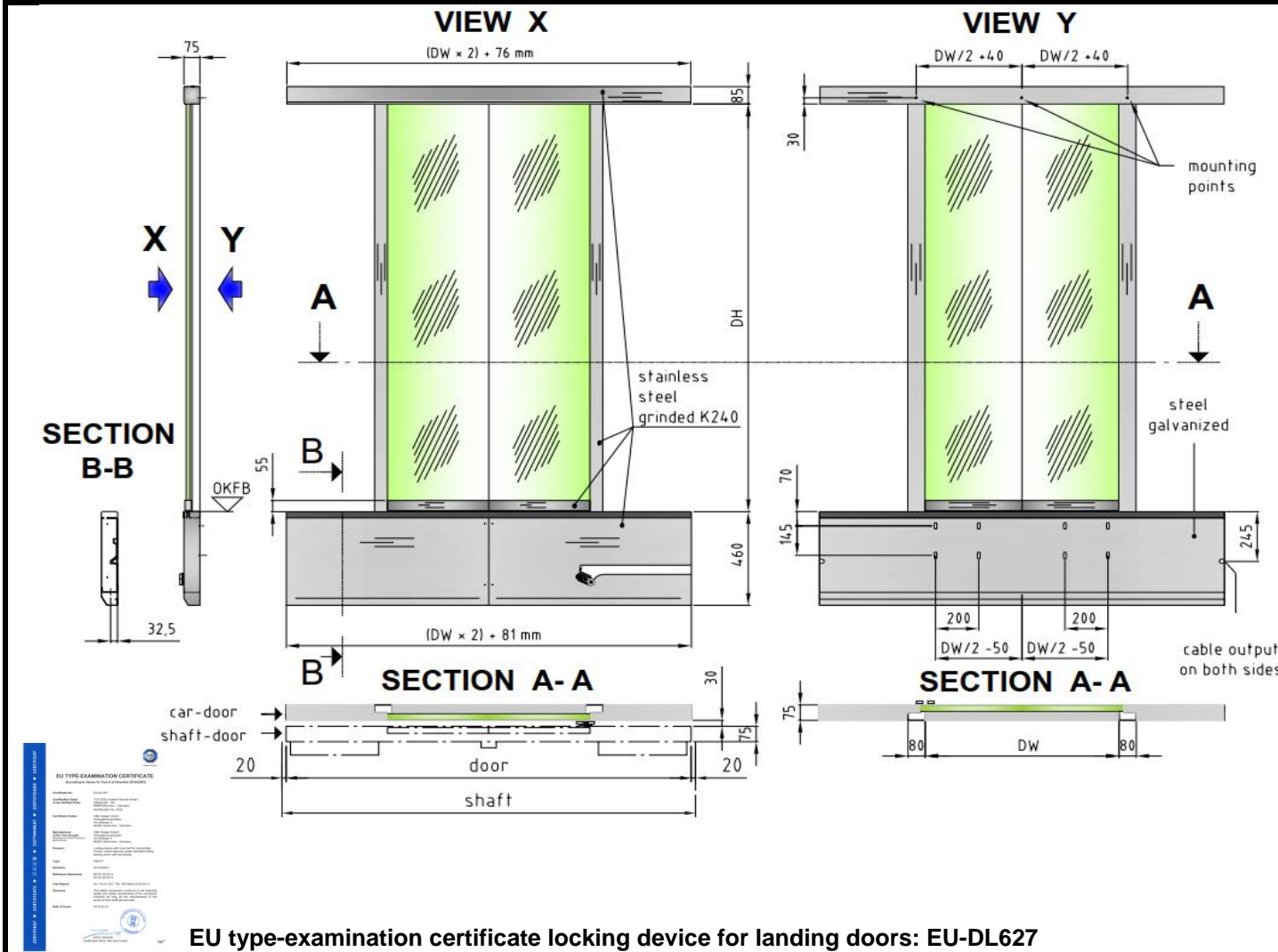

technical description
landing door:
DW 800 - 1400mm, DH 2000 - 3000mm
mechanism underneath
full glass door, VSG16 (bracket below)
door lock: hook bolt locking device
el. contact: IP20 splash water secured
unlocking device in the sill (triangle socket)
pieces stainless steel or electrogalvanized
attachment directly to the steel frame
load: DW 900 / DH 2100 approx. 175kg
options:
change of front apron hight
change of upper door frame width
el. contact shaft and car door: IP67
special attachment on customer's request
cover at back side in stainless steel
door leaf stainless steel
edge protector (0,8mm stainless steel)
special door frame
contact for emergnecy unlocking device



EU type-examination certificate locking device for landing doors: EU-DL627

specification for GBH glass car door **RSZ-S1**, door drive underneath

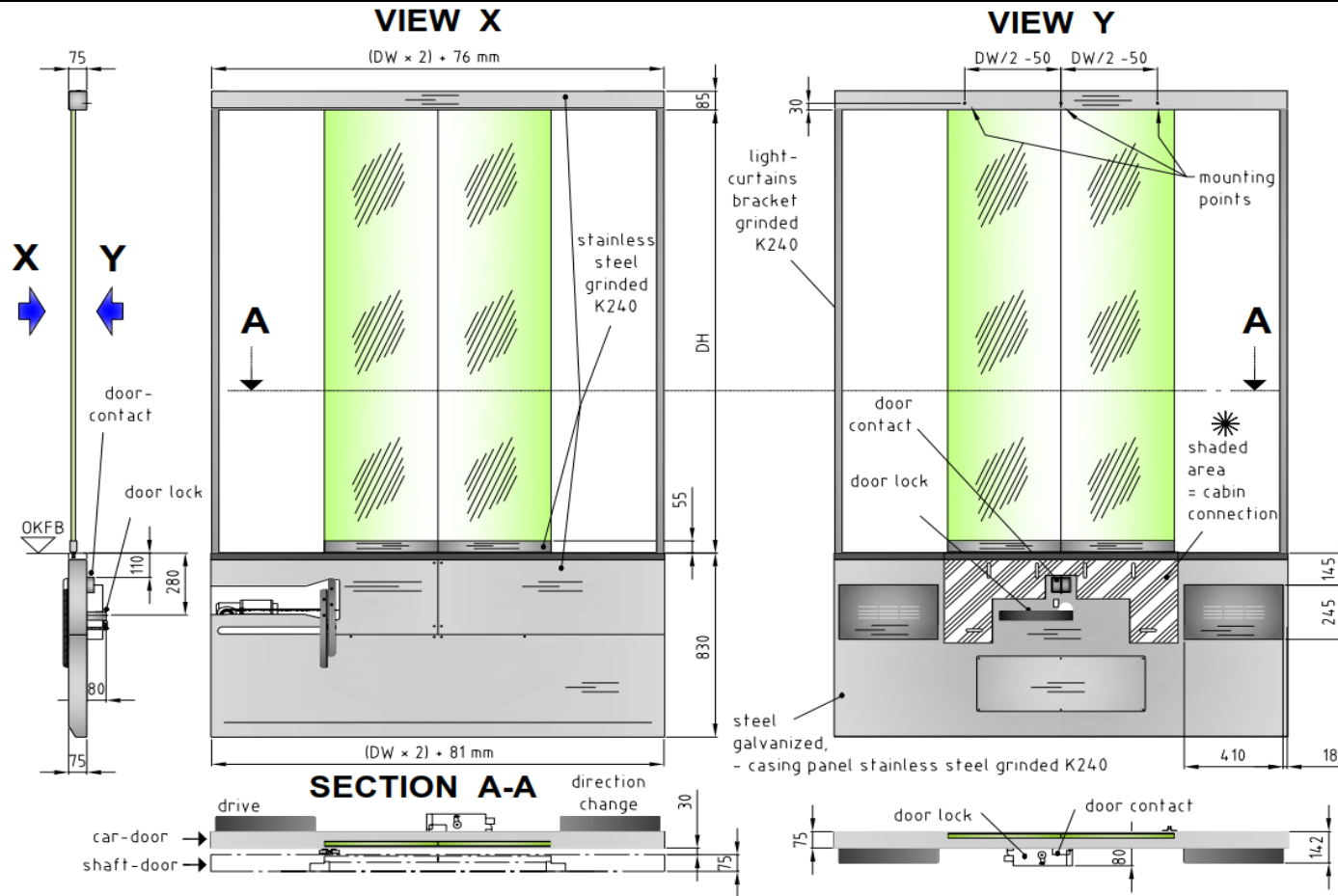

GBH Design GmbH	
Aufzugskomponenten	
Am Branden 2	
D-85256 Vierkirchen	
Technik Christian Gratzl	
Telefon: +49 8139 9321-316	www.gbh-design.de
Telefax: +49 8139 9321-301	

senden an: christian.gratzl@gbh-design.de

technical description car door:
DW 800 -1400mm, DH 2000 - 3000mm
mechanism underneath
full glass door, VSG16 (bracket below)
drive Siemens AT40
el. contact: IP67
pieces stainless steel or electrogalvanized
attachment directly to the cabine
load: DW 900 / DH 2100 approx. 240kg
options:
door leaf stainless steel
change of front apron hight
change of upper door frame width
special attachment on customer's request
special door-entrance on customer's request
light curtain with stainless steel bracket
car door-interlock type Kronenberg DL1MO GBH certificate locking device: G474/2
edge protector (0,8mm stainless steel)
cover at back side in stainless steel